



Euro Style Bags



Soft Touch Boxes

Adorn

PROMOTIONAL
PACKAGING

 **4-Color Process Print**



Rigid Folding Boxes



Wine Packaging



Gift Card Holders

Soft Touch Magnetic Boxes

Soft Touch refers to the box's unique upscale finish.
Includes Removable Gift Card insert.

4-Color Process Print

Minimum 50 Pieces



Black (BLA)



White (WHI)

Shown with 4 Color Process Printing

Also Available Screen Printed



Natural Kraft (KRA)



Pewter (PEW)

Product Code	Size	Ctn	Actual Wt	Price per EACH			
				50	100	200	300+
4-Color Process Print Soft Touch Magnetic Boxes							
PR-MBGS4___	4-7/8" x 3-7/8" x 7/8"	10	2.5	7.96	6.84	6.42	6.26 (4P)

Price above includes one side printing, product and ALL set up charges.

Must be ordered in full cases.
Production Time: 7-10 business days from proof approval
Subject to review of artwork and pricing if print area exceeds 75% of print surface.

Exact PMS colors are not possible as all colors are converted to CMYK. Reference a Pantone PMS color bridge to see how your PMS color will appear. Prices subject to review of art. Additional charges may apply to orders with excess ink coverage.

Custom Printed Euro Style Bags



4-Color Process Print

Minimum 100 Pieces

*Price includes:
One Side Printing, Product,
and ALL Setup Charges!*



Product Code	Size	Ctn	Price per EACH		
			100	300	500+
Twill Handle Bags (Bag Colors as shown on page 5)					
PR-MBMH5___	5" x 4" x 6"	100	4.86	4.18	4.00
PR-MBMH8___	8" x 4" x 10"	100	5.28	4.62	4.40
PR-MBMH10___	10" x 5" x 13"	100	6.82	6.16	5.94
PR-MBMH16___	16" x 6" x 12"	100	8.72	7.88	7.62
Wine Twill Handle Finish in Espresso (ESP), White (WHI), Black (BLA) & Chelsea Kraft (KRA)					
PR-MBMH415___	4-1/2" x 4-1/2" x 15"	100	5.64	5.08	4.86
Euro Bags with Rope Handles (Bag Colors as shown on page 3-4) * Insert G for Gloss Finish or M for Matte Finish					
PR-ET_*_5___	5" x 3-1/2" x 13"	100	5.62	5.00	4.74
PR-ET_*_6___	6-1/2" x 3-1/2" x 6-1/2"	100	4.84	4.12	3.92
PR-ET_*_8___	8" x 4" x 10"	100	5.18	4.44	4.24
PR-ET_*_9___	9" x 3-1/2" x 7"	100	5.52	4.90	4.68
PR-ET_*_13___	13" x 5" x 10"	100	6.56	5.84	5.56
PR-ET_*_16___	16" x 6" x 12"	100	8.38	7.46	7.12
100% Paper Euro Totes: White (WHI) & Natural Kraft (NAT) (Bag Colors as shown on page 4)					
PR-ETP5___	5" x 3-1/2" x 13"	100	6.12	5.04	4.56
PR-ETP6___	6-1/2" x 3-1/2" x 6-1/2"	100	5.82	4.74	4.30
PR-ETP8___	8" x 4" x 10"	100	6.08	5.00	4.54
PR-ETP16___	16" x 6" x 12"	100	7.86	6.76	6.18

(3P)

Price above includes one side printing, product and ALL set up charges.

Must be ordered in full cases.

Production Time: 7-10 business days from proof approval

Subject to review of artwork and pricing if print area exceeds 75% of print surface.

Exact PMS colors are not possible as all colors are converted to CMYK. Reference a Pantone PMS color bridge to see how your PMS color will appear. Prices subject to review of art. Additional charges may apply to orders with excess ink coverage.



Euro Bags Rope Handles

Matte Finish - PR-ETM



White (WHI)
All Sizes



Black (BLA)
All Sizes



Espresso (ESP)
M8, 16, 13 & 6



Cherry Red (RED)
M8, 16, 13 & 6



Navy (NAV)
M9, 8, 16, 13 & 6



Dark Green (DGR)
M8, 16 & 6



Regal Purple (REG)
M8, 16 & 6



Burgundy (BUR)
M8, 16 & 6



Euro Bags Rope Handles
Hi Gloss Finish - PR-ETG__



Gloss White (WHI)
G6, 8, 9, 13 & 16



Gloss Black (BLA)
G6, 8, 9, 13 & 16

Euro Bags Rope Handles
Matte Metallic Colors - PR-ETM__



Champagne (CHA)
M8, 13 & 6



Baroque Gold (BAR)
M8, 13 & 6



Platinum (PLA)
M8, 13, 6 & 5

100% Paper Euro Bags Paper Handles  ***PR-ETP__***



White (WHI)
All Sizes

Contains a minimum of 40% post consumer recycled material (180 gsm)



Natural Kraft (NAT)
All Sizes

Contains a minimum of 75% post consumer recycled material (200 gsm)



Twill Handle Bags

N *Uncoated with Natural Interior*
 Contains a minimum of 75% post consumer recycled material (200 gsm)



Natural Kraft (NKR)
 Sizes 8, 10 & 16

Navy (NVK)
 Sizes 5, 8, 10 & 16

Espresso (ESP)
 Sizes 4, 5, 8, 10 & 16

Chelsea Kraft (KRA)
 All Sizes

W *Uncoated with White Interior*
 Contains a minimum of 40% post consumer recycled material (180 gsm)



Black (BLA)
 All Sizes

White (WHI)
 All Sizes

Spruce Green (SPR)
 Sizes 5, 8, 10 & 16

Black Tie (BTI)
 Sizes 5, 8, 10 & 16

Bright Red (RED)
 Sizes 5, 8, 10 & 16

Light Gray (LGR)
 Sizes 5, 8, 10 & 16

Fuchsia (FUC)
 Sizes 5, 8, 10 & 16

Gray (GRA)
 Sizes 5, 8, 10 & 16



Rigid Folding Wine Boxes

4-Color Process Print

Minimum 50 Boxes



- Black Matte Anti Scratch finish now in 2-bottle
- Ships flat, easy open & fully collapsible
- Magnetic Closure
- Full length inserts included for BB2

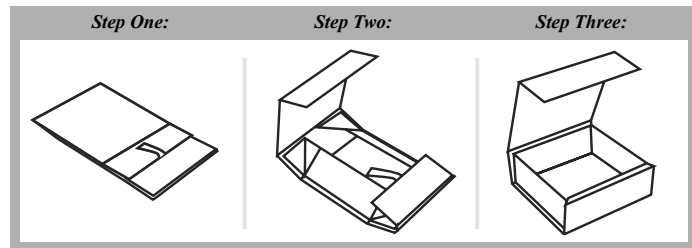

Product Code	Style	Actual Wt	Price per EACH			
			50	100	250	500
Process Printed - Rigid Folding Wine Boxes: Matte Black (MBLA) w/ Anti Scratch Finish & White Gloss (GWHI)						©
PR-RFBB1GWHI	13-1/2 x 3-1/2 x 3-1/2 (White Gloss Only)	0.8	16.66	15.50	14.84	14.66
PR-RFBB2___	13-1/2 x 7 x 3-1/2 w bottle inserts	1.1	25.20	23.92	23.14	22.90

(4P)

Rigid Folding Boxes - (Fully Collapsible) with Magnetic Closure

4-Color Process Print

Minimum 50 Pieces

**Price includes:
One Side Printing, Product,
and ALL Setup Charges!**



Product Code	Size	Actual Wt	Price per EACH			
			50	100	250	500
Process Printed Boxes: Matte Black (MBLA), Matte White (MWHI), Matte Silver (MSIL), White Gloss (GWHI) , or Natural Kraft (KRA)						©
PR-RF662___	6 x 6 x 2-3/4	0.4	14.34	13.20	12.56	12.40
PR-RF883___	8 x 8 x 3-1/8	0.7	17.28	16.10	15.44	15.24
PR-RF10104___	10 x 10 x 4-1/2	1.5	22.18	20.94	20.22	20.00
PR-RF1333G___	13-1/2 x 3-1/2 x 3-1/2 (White Gloss Only)	0.8	16.66	15.50	14.84	14.66
PR-RF1373___	13-1/2 x 7 x 3-1/2	1.1	25.20	23.92	23.14	22.90
PR-RF13105___	13 x 10-3/4 x 5-1/2	1.8	28.18	26.86	26.06	25.80

(4P)

Price above includes one side printing, product and ALL set up charges.

Must be ordered in full cases.
Production Time: 7-10 business days from proof approval
Subject to review of artwork and pricing if print area exceeds 75% of print surface.

Exact PMS colors are not possible as all colors are converted to CMYK. Reference a Pantone PMS color bridge to see how your PMS color will appear. Prices subject to review of art. Additional charges may apply to orders with excess ink coverage.



Italian Wine Packaging



4-Color Process Print
Minimum 60 Boxes

Price includes
One Side Printing, Product,
and ALL Setup Charges!

Product Code	Style	Size	Ctn	Price per EACH			
				60	120	300	600+
Wine Bottle Carriers							
PR-ITBS1	Sculpted 1 Bottle Carrier	3-1/2 x 3-1/2 x 15	100	6.36	5.32	4.78	4.66
PR-ITBC1	1 Bottle Carrier	3-1/2 x 3-1/2 x 15	50	6.48	5.44	4.88	4.76
PR-ITBC2	2 Bottle Carrier	7 x 3-1/2 x 15	30	7.12	6.02	5.54	5.40
PR-ITBC3	3 Bottle Carrier	10-5/8 x 3-1/2 x 15	30	8.78	7.66	7.04	6.88
PR-ITWT4	4 Bottle Open Style	7 x 7 x 13-3/4	30	7.80	6.70	6.12	5.98
PR-ITWT6	6 Bottle Open Style	10-5/8 x 7 x 13-3/4	30	8.38	7.28	6.66	6.52
Wine Bottle Boxes							
PR-ITBBMNER	Magnum 1 Bottle Box	4-1/2 x 4-1/2 x 16-3/4	20	6.90	5.82	5.34	5.20
PR-ITBB1	1 Bottle Box (Side Opening)	3-3/4 x 3-3/4 x 13-3/8	100	7.18	6.10	5.54	5.40
PR-ITBBV1TAW	1 Bottle Box (End Opening)	3-1/2 x 3-1/2 x 13-3/8	50	5.94	4.88	4.42	4.30
PR-ITBB2	2 Bottle Box (IT prefix)	7-1/4 x 3-1/2 x 13-3/8	30	10.24	9.08	8.40	8.24
PR-ITBB3	3 Bottle Box (IT prefix)	11 x 3-1/2 x 13-3/8	30	10.80	9.60	8.92	8.76

Price above includes one side printing, product and ALL set up charges.

Must be ordered in full cases.

Production Time: 7-10 business days from proof approval

Subject to review of artwork and pricing if print area exceeds 75% of print surface.

Exact PMS colors are not possible as all colors are converted to CMYK. Reference a Pantone PMS color bridge to see how your PMS color will appear. Prices subject to review of art. Additional charges may apply to orders with excess ink coverage.

IT Color Collection



(CON) (WHI) (NAV) (NAT) (WOO) (SNO) (ARG) (SBI) (PRO) (ORO) (PMA) (GRI) (NER) (TAW)



"Constellation"
Smooth Finish
1, 2 & 3 Bottle Carriers



"Sere Bianco"
Bubble Texture
1 & 2 Bottle Carriers



"White Kraft"
Smooth Finish
2 & 3 Bottle Carriers



Italian Wine Packaging



"Pelle Marrone"
Chocolate Pebble
2 & 3 Bottle Carriers



"Grigio"
Gray Groove
1, 2 & 3 Bottle Carriers



"Pelle Rosso"
Red Pebble
2 & 3 Bottle Carriers



BBM



BSI

BCI

"Nero"
Matte Black Linen
Bottle Carriers,
Bottle Side-Opening
and Bottle Boxes w/ inserts



BCI

BBVI

"Natural Kraft"
Smooth Finish
Bottle Carriers,
and Bottle Boxes w/ inserts



"Juta Blu"
Matte Navy Linen
Bottle Carriers,
and Bottle Boxes w/ inserts
E-Commerce Boxes



BBVI

"Tawny"
Textured Rib



Italian Wine Packaging



“Alpine Snowflake”
Linen Embossed
1, 2 & 3 Bottle Carriers,
Boxes, & Bags



“Oro”
Matte Gold Linen
Bottle Carriers,
Bottle Boxes w/ inserts
and Bottle Side-Opening



“Barn Wood”
Satin Embossed
1, 2 & 3 Bottle Carriers
Bottle Boxes w/ inserts



“Argento”
Metallic Silver Linen Foil
1, 2 & 3 Bottle Carriers,
Bottle Boxes w/ inserts
and Bottle Side-Opening



Open Style
White Kraft, Natural Kraft and Nero
4 & 6 Open Style Carriers